



ASSEMBLY / OPERATION INSTRUCTIONS



1,500LB CAPACITY

'Low Profile' Motorcycle Dolly

Model: 03-CG1500-01(B1)

WARNING

**BEFORE USE
PLEASE READ ALL WARNINGS AND
INSTRUCTIONS TO PREVENT SERIOUS INJURY**

Specifications

Max Weight Capacity	1,500 lbs
Dimensions	85”L x 33.2”W x 3.6”H
Surface Area	7’1” Length x 2’9” Width
(See Detailed Exploded Views & Parts List on pages 4 & 5)	

Assembly Instructions

- 1. Carefully unpack contents from box & check for missing or broken parts.**
(If any parts are found to be missing or broken, please contact Drop-Tail Trailers @ 877-284-9008.)
- 2. Mount only the 4ea Casters Wheels (9) to the center section of the V-Channel Platform (1), by utilizing the Flat Washers (10), Lock Washers (11) and Hex Nuts (12) and Caster Shim Spacers (15) as shown on the Exploded View.**
- 3. To mount the Casters at each end of the V-Channel, first locate the 2ea V-Channel Support Plates (3), 2ea Brackets A (6), 2ea Brackets B (7) and both the (Front & Rear) Ramp / Brake Assembly (4) & (5) before installing the end Casters.**
- 4. For the rear Casters and Rear Ramp / Brake assembly installation, first insert Bracket A (6) over the Rear Brake Lock handle (5) along with Bracket B (7) for the opposite side as shown in Exploded View.**
- 5. Repeat in the same manner for the front Casters and Front Ramp / Brake assembly as shown in Exploded View.**
- 6. Position V-Channel Support Plates (3) between Brackets A and B before connecting Front & Rear Ramp / Brakes Assemblies and Caster Wheels.**
- 7. Connect Front and Rear Ramp / Brake Assemblies (4) & (5) and V-Channel Support Plates (3) to the V-Channel Platform using the pair of Casters at each end.**
- 8. Locate the Kickstand Platform (2) to install the remaining two Casters along with Flat Washers (10), Lock Washers (11), Hex Nuts (12) and Caster Shim Spacer (15) as shown.**

NOTE: Ensure Washers & Caster Shim Spacers are installed correctly, according to Exploded View, make certain Casters are on same plane for proper function.

- 9. Mount the Kickstand Platform (2) to V-Channel Platform (1) using Flat Washers (10), Lock Washers (11) Hex Nuts (12) and Hex Bolts (14) as shown in Exploded View.**
- 10. Apply the 12ea Plastic Caps (13) to all Hex Nuts. Press to secure. Also, insert both Wheel Stop Bars (8) into slots at each end of Cycle Glyder.**

Operation Instructions

WARNINGS

- Before each use, check that Caster Wheels roll freely and are in proper working condition.
- Do not exceed maximum load capacity of 1,500 lbs.
- Only use CYCLE GLYDER on level, dry surface that can handle a maximum weight distribution.
- Do not let children play on or around GLYDER when loaded or unloaded.

Loading Procedure:

1. Ensure the Front and Rear Ramp / Brake Assembly are fully engaged to position the Caster Wheels off the floor surface.
2. Remove the rear Wheel Stop Bar.
3. Pay close attention to properly center the bike in-line with the center of the CYCLE GLYDER V-Channel Platform.
4. Slowly and carefully ride or walk the bike onto the CYCLE GLYDER until the front wheel contacts the front Wheel Stop Bar.
5. Ensure the bike's power is turned off and in 1st gear.
6. Drop the kickstand to fit into the center of the Kickstand Platform.

NOTE: for proper function, ensure the kickstand is positioned in the center of the Kickstand Platform by adjusting to 1 of 7 'front to back' possible positions.

7. Allow bike to rest in its natural kickstand position on the CYCLE GLYDER & Kickstand Platform.
8. Insert rear Wheel Stop Bar.

NOTE: for bikes with long wheel bases, it may not be necessary to insert rear Wheel Stop Bar.

9. Disengage both the front & rear Ramp / Brake Assemblies to allow the CYCLE GLYDER to rest on the Caster Wheels.
10. Your bike is now ready to 'Glyde' against a wall or corner area.

CAUTION

To avoid the potential of tipping the bike over, slowly and carefully move the GLYDER - paying close attention not to hit or jar while loaded.

Unloading Procedure:

1. Carefully rotate the 'loaded' CYCLE GLYDER to a position where you have enough room to safely ride off or walk off.

NOTE: If there is not enough room to fully rotate the CYCLE GLYDER to ride off, it may be necessary to carefully back off by pushing or walking the bike off the CYCLE GLYDER.

2. Engage both, the rear and front Ramp / Brake Assemblies to position the Caster Wheels off the floor surface.
3. Slowly and carefully ride or walk the bike off of the CYCLE GLYDER.

WARNING

To avoid injury, keep Hands, Fingers and Feet from underneath the CYCLE GLYDER at all times.

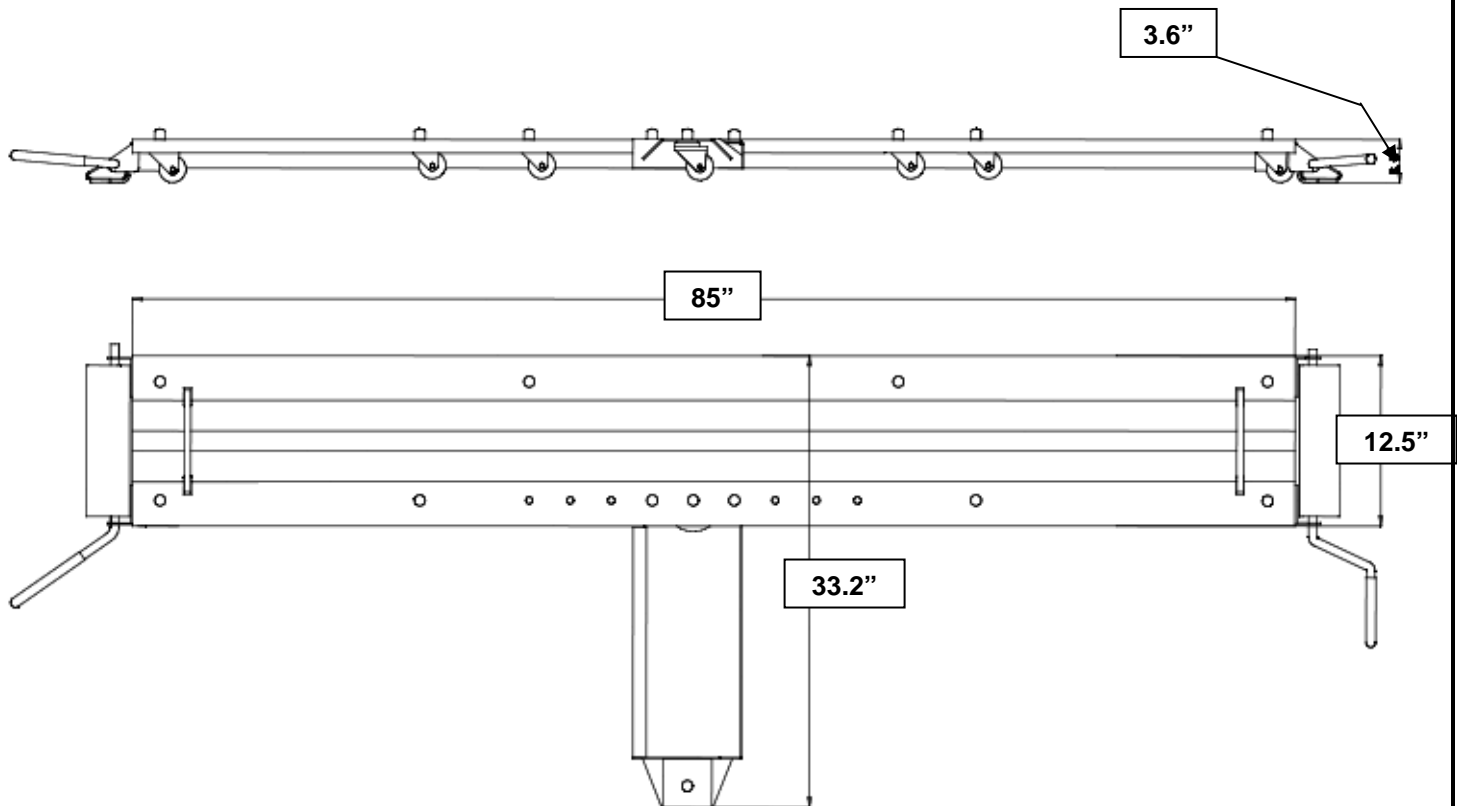

Exploded View / Parts List

CYCLE GLYDER

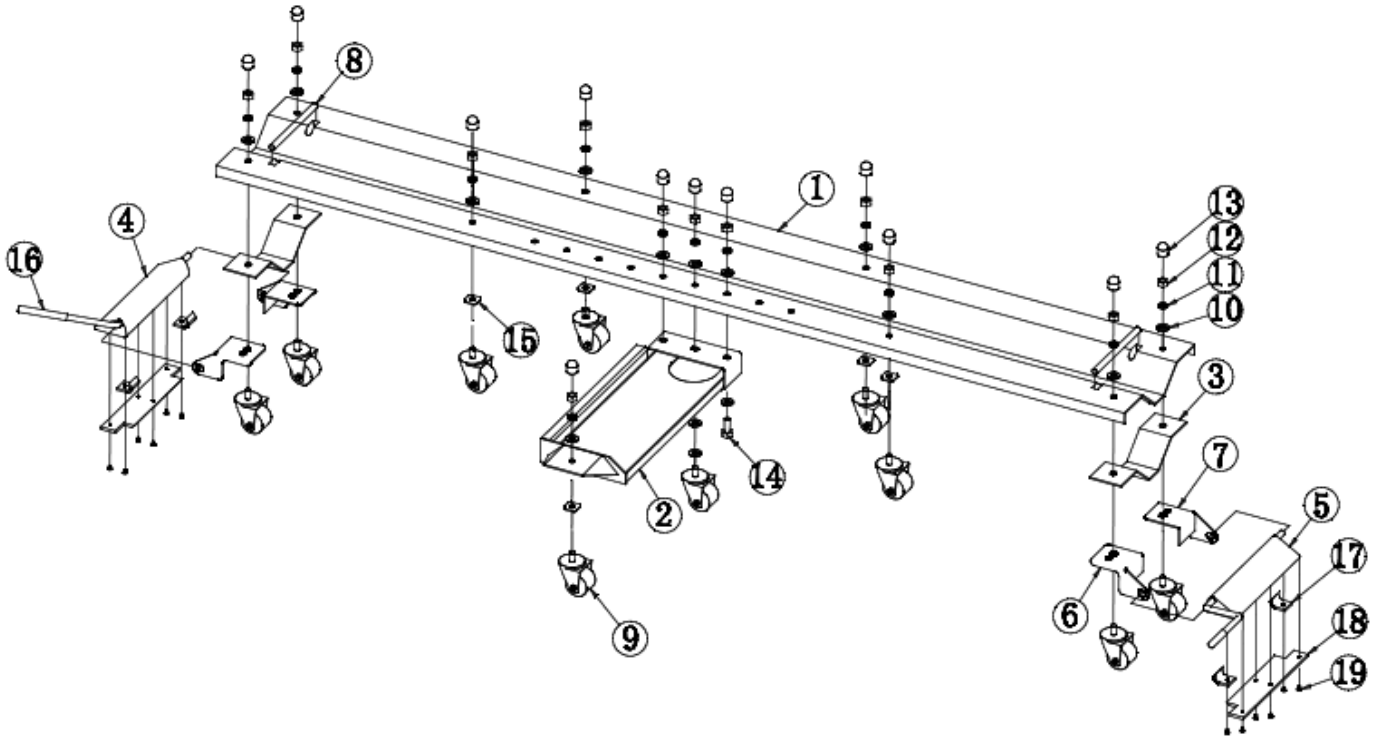

Item	Part Number	Description	Qty
1	CG-1010(A)	CG V-Channel Platform (A)	1
2	CG-1020(A)	Kickstand Platform (A)	1
3	CG-1051	V-Channel Support Plate	2
4	CG-1030(A)	Front - Ramp / Brake Assy. (A)	1
5	CG-1040(A)	Rear - Ramp / Brake Assy. (A)	1
6	CG-1053A(A)	Bracket A, Ramp / Brake (A)	2
7	CG-1053B(A)	Bracket B, Ramp / Brake(A)	2
8	CG-1052	Wheel Stop Bar	2
9	92020122W	Caster Wheel 1/2"-13, Dia. 2"	10
10	30120002W	Flat Washer ϕ 12mm	16
11	31130002W	Lock Washer 1/2"	12
12	40120132W	Hex Nut 1/2"-13	12
13	92120132B	Plastic Cap, 1/2" Hex Nut	12
14	14121002W	Hex Bolt 1/2"-13x1"	2
15	CG-1054	Caster Shim Spacer	5
16	92160002Y	Vinyl Yellow Sleeve 5/8"	2
17	CG-1063	Pivot Cam, Ramp / Brake	4
18	CG-1062(A)	Rubber Pad, Ramp / Brake	2
19	28050122W	Hex Screw 'countersink' M5x12mm	12

LIMITED WARRANTY POLICY

Limited Warranty Periods:

- **Hunting Equipment:** 1 Year (12 months) from the date of purchase.
- **Trailer Products:** 1 Year (12 months) from the original date of purchase.
- **Hydraulic Cylinders, Rams, Hose Assemblies, and Fittings:** 2 Years (24 months) from the date of purchase.
- **Sub-Component Items:** Many sub-component items are warranted separately by the respective manufactures and are covered by warranty of their manufacturer. Examples of such items may include safety harnesses and tie-down systems, wheels, tires, axles, bearings, lights, straps, chain, hardware and like items. The sub-components original manufactures product warranty supersedes and takes precedence over this limited warranty policy.

NOTE: ALL WARRANTY CLAIMS MUST BE PREAPPROVED BY THE MANUFACTURER (THE COMPANY) TO BE VALID.

Products are warranted to be free of defects in materials and/or workmanship for the warranty period. Under this limited warranty, the Company shall be limited to repairing or replacing, at its option, for the warranty period, those parts returned to the factory, freight prepaid, which in the opinion of the Company shall prove to be defective in materials or workmanship, under normal use and service. This warranty will not apply unless the product is installed, used and maintained in accordance with the Manufacturers installation, operation and maintenance instructions.

This warranty applies to the **ORIGINAL** purchaser only, and is non-transferable. The Company warrants the products to be free of defects in material and workmanship but, does not cover normal maintenance or adjustments, damage or malfunction caused by: improper handling, installation, abuse, misuse, negligence, carelessness of operation or normal wear and tear. In addition, this warranty does not cover equipment when repairs or alterations have been made or attempted without the express written consent of the company. Product repairs not covered by the warranty, and product updates, will be provided at the prevailing rate.

The Company is not responsible for damage caused by accident, negligence, abuse, overloading, misapplication, or misuse of the products. It is solely the purchaser's responsibility to determine the suitability of these products for the particular application. **Limitations:** All other obligations or liabilities, including incidental or consequential damages or contingent liabilities arising out of the failure of any parts to operate properly are hereby excluded, including but not limited to any damages resulting from loss of use, inconvenience, loss of time, commercial loss, or any other type of damages general or specific, foreseen or unforeseen, unless applicable state law provides otherwise.

THIS WARRANTY IS EXCLUSIVE AND IS IN LIEU OF ALL OTHER WARRANTIES EXPRESSED OR IMPLIED INCLUDING ANY IMPLIED WARRANTY OR MERCHANTABILITY OR ANY IMPLIED WARRANTY OF FITNESS FROM A PARTICULAR PURPOSE, AND ALL SUCH IMPLIED WARRANTIES ARE EXPRESSLY EXCLUDED.

THE REMEDIES DESCRIBED ARE EXCLUSIVE AND IN NO EVENT SHALL THE COMPANY, NOR ANY SALES AGENT OR OTHER COMPANIES AFFILIATED WITH IT OR THEM, BE LIABLE FOR SPECIAL CONSEQUENTIAL OR INCIDENTAL DAMAGES FOR THE BREACH OF OR DELAY IN PERFORMANCE OF THIS WARRANTY. THIS INCLUDES, BUT IS NOT LIMITED TO, LOSS OF PROFIT, RENTAL OR SUBSTITUTE EQUIPMENT OR OTHER COMMERCIAL LOSS.

This warranty shall be governed by the laws of the State of Texas, and shall be subject to the exclusive jurisdiction of the Court in the State of Texas in the County of Tarrant.

RETURNS: Products may not be returned without written approval (Return Material Authorization) from the Company.

Direct Outdoor Products, Drop Tail Trailers, United Hydraulics, LLC

Rev04152008